

THINK TECH FORWARD

股票代码: 300415

Stock code

伊之密品牌管理部策划 | 2025年06月版

YIZUMI

YR

注塑机专用机械手

YIZUMI ROBOT FOR IMM

广东伊之密进出口有限公司

Yizumi International Business Co., Ltd.

ADD: 广东省佛山市顺德区容桂街道高黎社区顺德高新区(容桂)科苑三路22号之二
Address: No.22-2 Ke Yuan 3rd Road, Shunde, Foshan, Guangdong 528300, China
TEL: 400-802-6888(China) 86-757-2921 9001(Overseas)
Email: marketing@yizumi.com(China) imm@yizumi.com (Overseas)
www.yizumi.com

【免责声明 DISCLAIMER】

[1] 本公司保留对样本中描述产品进行改进的权利, 规格如有变更, 恕不另行通知。

YIZUMI reserves the right to modify the product description in the catalogue. Specification might be changed without prior notice.

[2] 样本中的产品照片仅供参考, 产品以实物为准。

The picture in the catalogue is for reference only. The real object should be considered as final.

[3] 样本中数据为伊之密厂内测试检验得出, 仅作为参考信息, 不保证是最新数据, 一切以实际产品为准。

The data in the catalogue is obtained from internal testing in YIZUMI laboratory.

Please refer to the actual machine for the final data. YIZUMI reserves the right of final interpretation upon disputes and ambiguities.



THINK TECH FORWARD



PRODUCT DETAILS

YR机械手机型编码规则

YR ROBOT NAME EXPLANATION

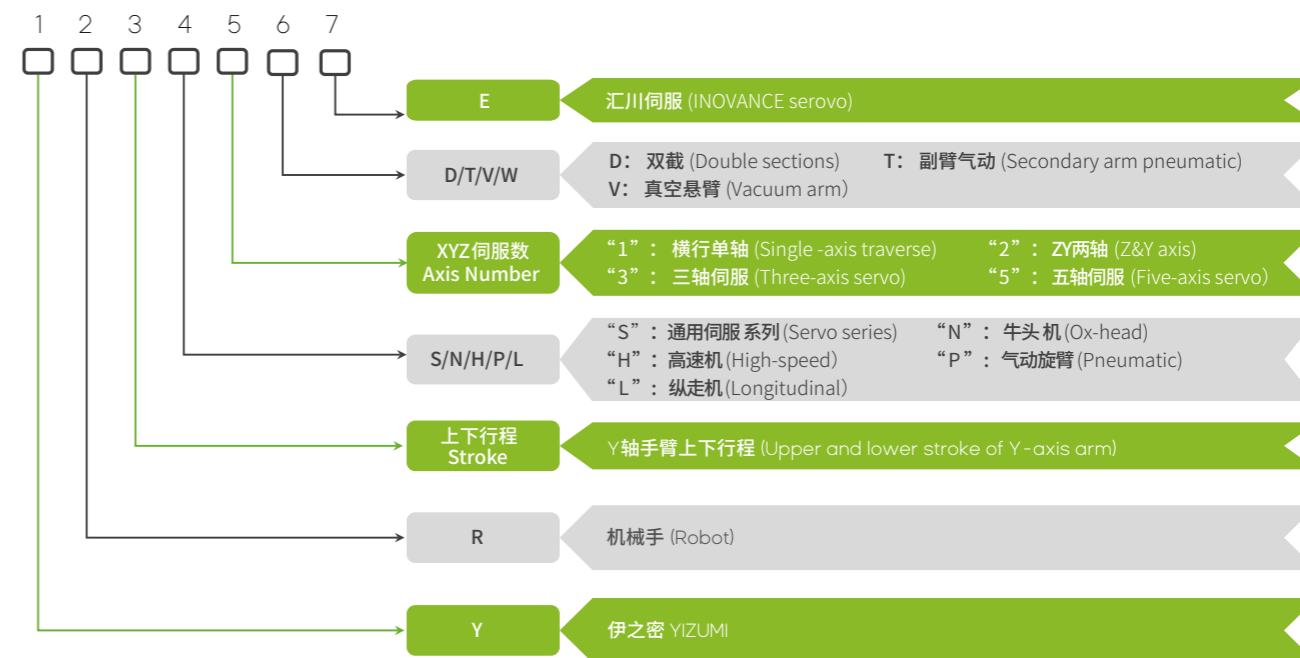

YR机械手选型指导

YR ROBOT SELECTION GUIDE

机械手 Robot	型号 Model	适用注塑机 Recommended IMM (Ton)	30	60	90	120	160	200	260	320	350	400	450	480	500	560	650	700	800	1000	1100	1200	1300	1400	1600	1800	2000	2100	2200	2400	2600	2700	3200	4000	
气动旋臂机械手 Pneumatic sprue picker	YR550PV	30-150	■																																
小型三轴横走式 机械手 Small-sized three-axis traverse robot	YR800S3	50-230		■	■	■	■	■																											
	YR1000S3	100-350			■	■	■	■	■	■																									
	YR1000S3-D	150-350				■	■	■	■	■																									
	YR800S3-E	50-230		■	■	■	■	■																											
	YR1000S3-E	150-350				■	■	■	■	■																									
	YR1000S3-DE	150-350				■	■	■	■	■																									
	YR1200S3-DE	200-550					■	■	■	■	■	■	■	■	■	■																			
小型五轴横走式 机械手 Small-sized five-axis traverse robot	YR800S5	50-230		■	■	■	■	■																											
	YR1000S5	100-350			■	■	■	■	■	■																									
	YR1000S5-D	150-350				■	■	■	■	■																									
	YR800S5-E	50-200		■	■	■	■	■																											
	YR1000S5-E	150-350				■	■	■	■	■																									
	YR1000S5-DE	150-350				■	■	■	■	■																									
	YR1200S5-DE	200-550					■	■	■	■	■	■	■	■	■	■																			
中型三轴横走式机械手 Medium-sized three-axis traverse robot	YR1200S3-D	200-550					■	■	■	■	■	■	■	■	■																				
	YR1500S3-D	450-1000										■	■	■	■	■	■	■	■	■	■														
中型五轴横走式机械手 Medium-sized five-axis traverse robot	YR1200S5-D	200-550						■	■	■	■	■	■	■	■																				
	YR1500S5-D	450-1000										■	■	■	■	■	■	■	■	■	■														
大型三轴机械手 (牛头式) Large-sized three-axis robot (OX head type)	YR1800N3-D	500-1300												■	■	■	■	■	■	■	■	■	■												
	YR2200N3-D	700-1800													■	■	■	■	■	■	■	■	■	■	■	■	■	■	■	■	■	■	■	■	■
	YR2500N3-D	1000-2500															■	■	■	■	■	■	■	■	■	■	■	■	■	■	■	■	■	■	■
	YR3000N3-D	1500-4000																			■	■	■	■	■	■	■	■	■	■	■	■	■	■	■
高速机械手 High speed robot	YR1200H3-D	150-450				■	■	■	■	■	■	■	■	■																					
模内贴标系统 In-mold labeling system	YR833-S6	150-450				■	■	■	■	■	■	■	■	■																					
	YR850-S3	350-700								■	■	■	■	■	■	■	■	■	■	■	■														
	YR833S	150-450				■	■	■	■	■	■	■	■	■																					

※ 页面所有数据均来源于伊之密工厂，请以实际定制设备情况为准。
The Data above were acquired by testing in the factory, only for your reference.
The specific data please accord to the actual equipment.

气动旋臂机械手

PNEUMATIC SPRUE PICKER



采用铸件工艺

Adopting die casting processing



刚性高,吸震性好

High rigidity and good shock-absorbing effect

气缸缓冲手臂

Cushion cylinder

手臂上下采用气缸缓冲,手臂电气全浪管保护,轻巧耐用。

Robot arms are adopted with cushion cylinder, and wave pipe for electric wire protection, light and reliable.

置物方向

Installation position

产品前后安全门放置可任意调整,模内对位快速安全。

Robot arms can be arbitrarily installed at the front or rear safety doors, with quick and safety para-position in mold.

性价比高

High cost-effective

性价比高,全气动驱动模式。

High cost-effective, robots are driven pneumatic servo.

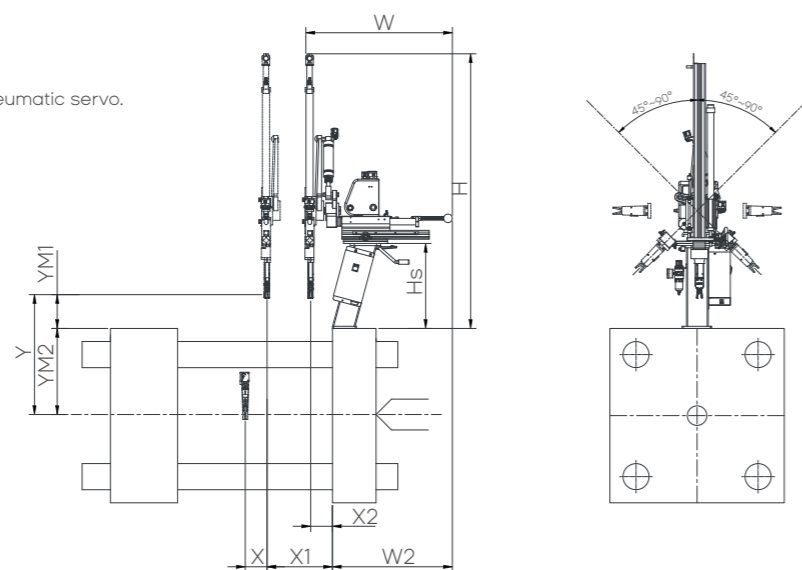

产品参数 Specification

机型 Model	轴数 Axis	主臂最远位置 Farthest Position of Main Arm	主臂引拔行程 Crosswise Stroke of Main Arm	副臂最远位置 Farthest Position of Auxiliary Arm	副臂引拔行程 Crosswise Stroke of Auxiliary Arm	副臂最近位置 Closest Position of Auxiliary Arm	手臂上下行程 Arm's Upper /Lower Stroke	待机高度 Standby Height	安装面下行长度 Downward Stroke of Mounting Surface	机器宽度 Machine Width	机器长度 Machine Length	横行行程 Traverse Stroke	机器高度 Machine Height	底座高度 Base Height	负载 Load	适用注塑机 Applicable Injection Molding Machine
		X1 (mm)	X2 (mm)	X3 (mm)	X4 (mm)	X5 (mm)	Y (mm)	YM1 (mm)	YM2 (mm)	W (mm)	L (mm)	Z (mm)	H (mm)	Hs (mm)	Payload (kg)	IMM (ton)
YR550PV	/	300	100	/	/	/	550	155	395	/	/	/	1275	390	2	30-150

※ 页面所有数据均来源于伊之密工厂, 请以实际定制设备情况为准
The Data above were acquired by testing in the factory, only for your reference.
The specific data please accord to the actual equipment.

小型三轴横走式机械手

SMALL-SIZED THREE-AXIS TRAVERSE ROBOT



低噪音
Low noise



超高速
High speed



高精度
High precision



低震动
Low vibration

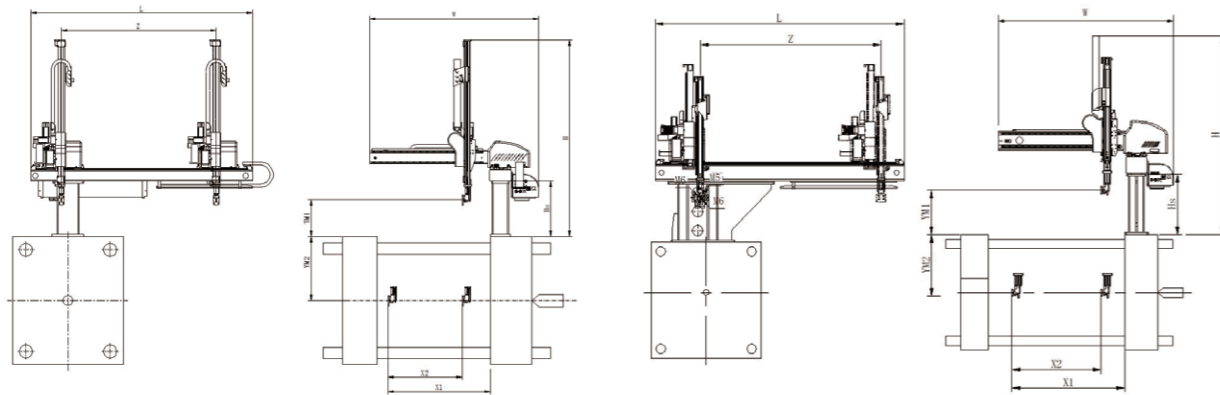

YR800S3&YR1000S3

YR1000S3-D



标配表 Standard Features

- ▶ 标准治具
- ▶ 两吸两抱
- ▶ 语言:中英文
- ▶ 开放式自由编程
- ▶ 输送带启动信号
- ▶ 松下伺服
- ▶ Standard jig
- ▶ Two sets of clip & suction
- ▶ Language: Chinese/English
- ▶ Open programming
- ▶ Conveyor start signal
- ▶ PANASONIC servo

选配表 Optional Features

- ▶ 快换治具模块
- ▶ 水口剪刀系统
- ▶ 可选多组吸抱回路
- ▶ 可选定制语言
- ▶ 正反向置物可选
- ▶ 可选欧67/欧12接口
- ▶ 可选配双截
- ▶ 导轨供油润滑系统
- ▶ 中板模到位安全检测
- ▶ 围栏门型外安全检测
- ▶ Quick switch jig
- ▶ Sprue shearing system
- ▶ Multi-set clip & suction circuits available
- ▶ Default language selectable
- ▶ Select from forward and backward placement positions
- ▶ Select from Euromap 67 and Euromap 12 interfaces
- ▶ Double sections
- ▶ Lubrication system for guide rail
- ▶ Safety inspection of middle plate mold
- ▶ Safety inspection of fence door

产品参数 Specification

机型 Model	轴数 Axis	主臂最远位置 Farthest Position of Main Arm X1 (mm)	主臂引拔行程 Crosswise Stroke of Main Arm X2 (mm)	副臂最远位置 Farthest Position of Auxiliary Arm X3 (mm)	副臂引拔行程 Crosswise Stroke of Auxiliary Arm X4 (mm)	副臂最近位置 Closest Position of Auxiliary Arm X5 (mm)	手臂上下行程 Arm's Upper /Lower Stroke Y (mm)	待机高度 Standby Height YM1 (mm)	安装面下行长度 Downward Stroke of Mounting Surface YM2 (mm)	机器宽度 Machine Width W (mm)	机器长度 Machine Length L (mm)	横行程 Traverse Stroke Z (mm)	机器高度 Machine Height H (mm)	底座高度 Base Height Hs (mm)	负载 Load Payload (kg)	适用注塑机 Applicable Injection Molding Machine IMM (ton)
YR800S3	3	925	670	/	/	/	800	350	450	1530	1800	1400	1800	530	3	50-230
YR1000S3	3	925	670	/	/	/	1000	350	650	1530	2420	1750	2040	530	3	100-350
YR1000S3-D	3	1060	840	/	/	/	1000	420	580	1690	2340	1700	1920	570	8	150-350

※ 页面所有数据均来源于伊之密工厂，请以实际定制设备情况为准
The Data above were acquired by testing in the factory, only for your reference.
The specific data please accord to the actual equipment.

小型三轴横走式机械手

SMALL-SIZED THREE-AXIS TRAVERSE ROBOT



低噪音
Low noise



超高速
High speed



高精度
High precision



低震动
Low vibration

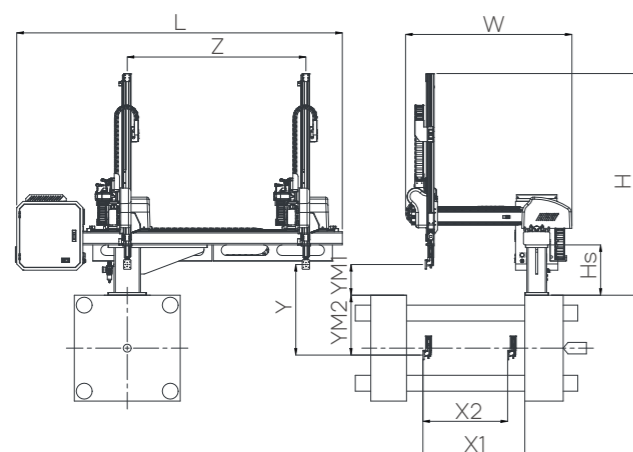

YR800S3-E & YR1000S3-E

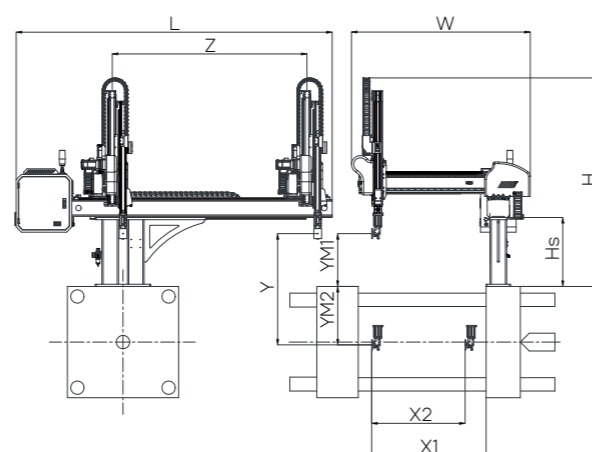

YR1000S3-DE & YR1200S3-DE

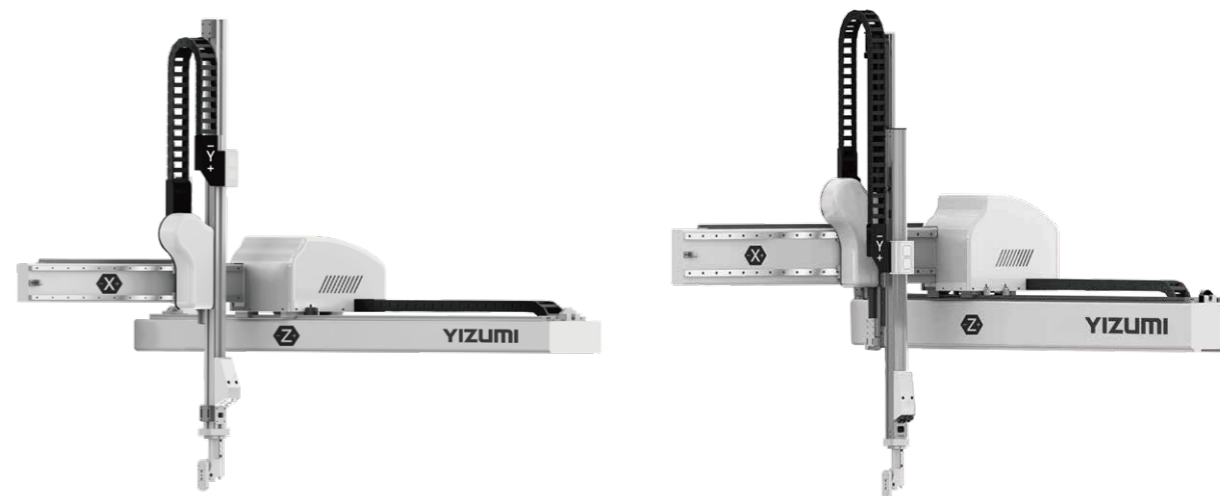

标配表 Standard Features

- ▶ 标准治具
- ▶ 两吸两抱
- ▶ 语言:中英文
- ▶ 开放式自由编程
- ▶ 输送带启动信号
- ▶ 汇川伺服
- ▶ Standard jig
- ▶ Two sets of clip & suction
- ▶ Language: Chinese/English
- ▶ Open programming
- ▶ Conveyor start signal
- ▶ INOVANCE servo

选配表 Optional Features

- ▶ 快换治具模块
- ▶ 水口剪刀系统
- ▶ 可选多组吸抱回路
- ▶ 可选定制语言
- ▶ 正反向置物可选
- ▶ 可选欧67/欧12接口
- ▶ 可选配双截
- ▶ 导轨供油润滑系统
- ▶ 中板模到位安全检测
- ▶ 围栏门型外安全检测
- ▶ Quick switch jig
- ▶ Sprue shearing system
- ▶ Multi-set clip & suction circuits available
- ▶ Default language selectable
- ▶ Select from forward and backward placement positions
- ▶ Select from Euromap 67 and Euromap 12 interfaces
- ▶ Double sections
- ▶ Lubrication system for guide rail
- ▶ Safety inspection of middle plate mold
- ▶ Safety inspection of fence door

产品参数 Specification

机型 Model	轴数 Axis	主臂最远位置 Farthest Position of Main Arm	主臂引拔行程 Crosswise Stroke of Main Arm	副臂最远位置 Farthest Position of Auxiliary Arm	副臂引拔行程 Crosswise Stroke of Auxiliary Arm	副臂最近位置 Closest Position of Auxiliary Arm	手臂上下行程 Arm's Upper /Lower Stroke	待机高度 Standby Height	安装面下行长度 Downward Stroke of Mounting Surface	机器宽度 Machine Width	机器长度 Machine Length	横行程 Traverse Stroke	机器高度 Machine Height	底座高度 Base Height	负载 Load	适用注塑机 Applicable Injection Molding Machine
		X1 (mm)	X2 (mm)	X3 (mm)	X4 (mm)	X5 (mm)	Y (mm)	YM1 (mm)	YM2 (mm)	W (mm)	L (mm)	Z (mm)	H (mm)	Hs (mm)	Payload (kg)	IMM (ton)
YR800S3-E	3	980	820	/	/	/	800	385	415	1500	2320	1350	1840	530	3	50-230
YR1000S3-E	3	980	820	/	/	/	1000	385	615	1500	2640	1700	2080	530	3	150-350
YR1000S3-DE	3	1025	840	/	/	/	1000	475	525	1610	2780	1750	1930	620	8	150-350
YR1200S3-DE	3	1025	840	/	/	/	1200	475	725	1610	3020	2000	2050	620	8	200-550

※ 页面所有数据均来源于伊之密工厂, 请以实际定制设备情况为准
The Data above were acquired by testing in the factory, only for your reference.
The specific data please accord to the actual equipment.

小型五轴横走式机械手

SMALL-SIZED FIVE-AXIS TRAVERSE ROBOT



低噪音
Low noise



超高速
High speed



高精度
High precision



低震动
Low vibration

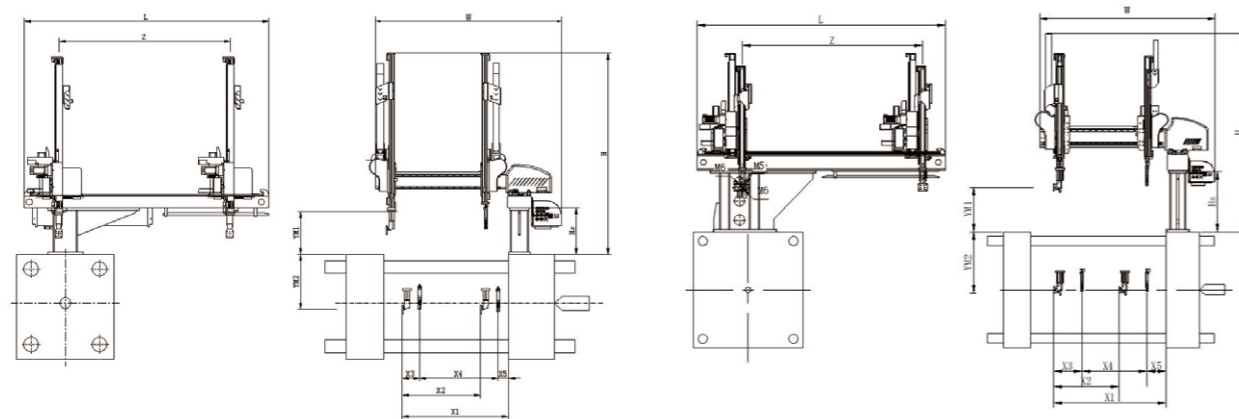
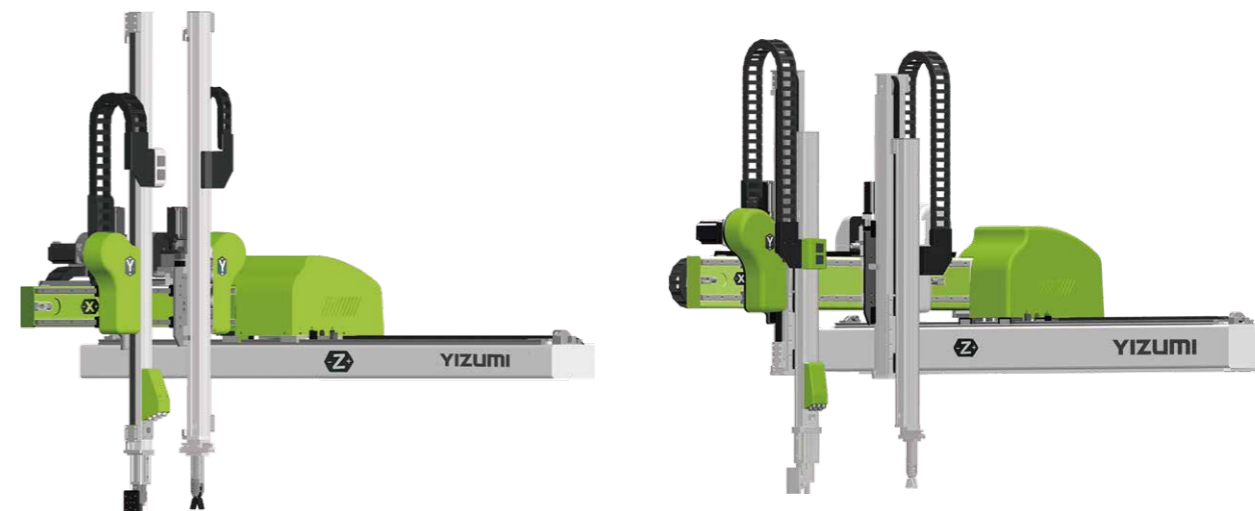

YR800S5&YR1000S5

YR1000S5-D

标配表 Standard Features

- ▶ 标准治具
- ▶ 两吸两抱
- ▶ 语言:中英文
- ▶ 开放式自由编程
- ▶ 输送带启动信号
- ▶ 松下伺服
- ▶ Standard jig
- ▶ Two sets of clip & suction
- ▶ Language: Chinese/English
- ▶ Open programming
- ▶ Conveyor start signal
- ▶ PANASONIC servo

选配表 Optional Features

- ▶ 快换治具模块
- ▶ 水口剪刀系统
- ▶ 可选多组吸抱回路
- ▶ 可选定制语言
- ▶ 正反向置物可选
- ▶ 可选欧67/欧12接口
- ▶ 可选配双截
- ▶ 导轨供油润滑系统
- ▶ 中板模到位安全检测
- ▶ 围栏门型外安全检测
- ▶ Quick switch jig
- ▶ Sprue shearing system
- ▶ Multi-set clip & suction circuits available
- ▶ Default language selectable
- ▶ Select from forward and backward placement positions
- ▶ Select from Euromap 67 and Euromap 12 interfaces
- ▶ Double sections
- ▶ Lubrication system for guide rail
- ▶ Safety inspection of middle plate mold
- ▶ Safety inspection of fence door

产品参数 Specification

机型 Model	轴数 Axis	主臂最远位置 Farthest Position of Main Arm	主臂引拔行程 Crosswise Stroke of Main Arm	副臂最远位置 Farthest Position of Auxiliary Arm	副臂引拔行程 Crosswise Stroke of Auxiliary Arm	副臂最近位置 Closest Position of Auxiliary Arm	手臂上下行程 Arm's Upper /Lower Stroke	待机高度 Standby Height	安装面下行长度 Downward Stroke of Mounting Surface	机器宽度 Machine Width	机器长度 Machine Length	横行程 Traverse Stroke	机器高度 Machine Height	底座高度 Base Height	负载 Load	适用注塑机 Applicable Injection Molding Machine
		X1 (mm)	X2 (mm)	X3 (mm)	X4 (mm)	X5 (mm)	Y (mm)	YM1 (mm)	YM2 (mm)	W (mm)	L (mm)	Z (mm)	H (mm)	Hs (mm)	Payload (kg)	IMM (ton)
YR800S5	5	875	645	145	645	85	800	350	450	1530	2000	1400	1800	530	3	50-230
YR1000S5	5	875	645	145	645	85	1000	350	650	1530	2420	1800	2040	530	3	100-350
YR1000S5-D	5	1060	615	265	615	180	1000	420	580	1590	2340	1700	1920	570	8	150-350

* 页面所有数据均来源于伊之密工厂，请以实际定制设备情况为准
The Data above were acquired by testing in the factory, only for your reference.
The specific data please accord to the actual equipment.

小型五轴横走式机械手

SMALL-SIZED FIVE-AXIS TRAVERSE ROBOT



低噪音
Low noise



超高速
High speed



高精度
High precision



低震动
Low vibration

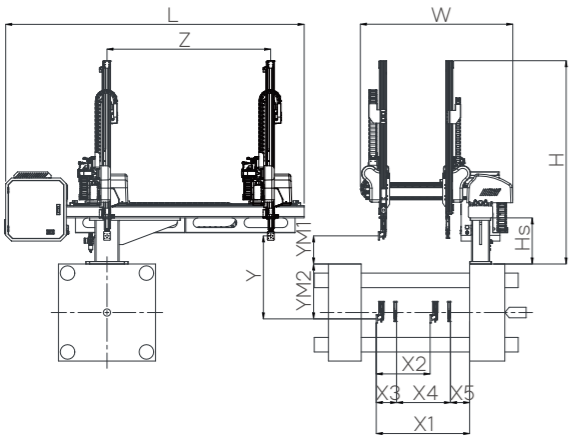
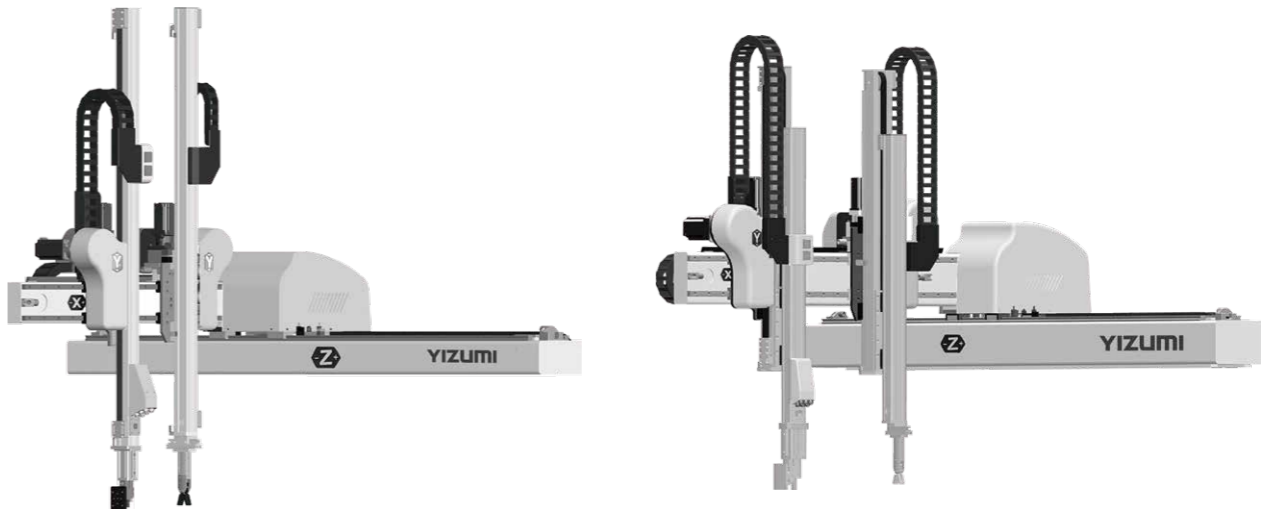

YR800S5-E & YR1000S5-E

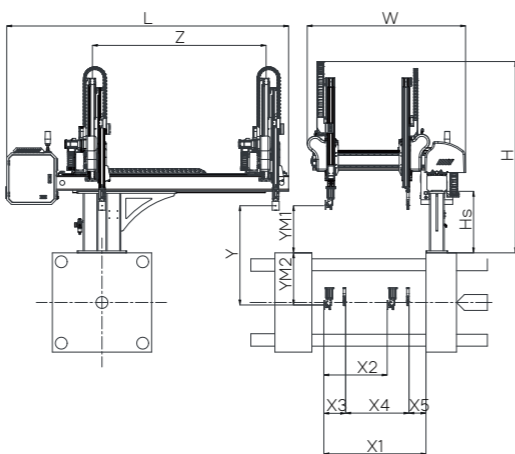

YR1000S5-DE & YR1200S5-DE

标配表 Standard Features

- ▶ 标准治具
- ▶ 两吸两抱
- ▶ 语言:中英文
- ▶ 开放式自由编程
- ▶ 输送带启动信号
- ▶ 汇川伺服
- ▶ Standard jig
- ▶ Two sets of clip & suction
- ▶ Language: Chinese/English
- ▶ Open programming
- ▶ Conveyor start signal
- ▶ INOVANCE servo

选配表 Optional Features

- ▶ 快换治具模块
- ▶ 水口剪刀系统
- ▶ 可选多组吸抱回路
- ▶ 可选定制语言
- ▶ 正反向置物可选
- ▶ 可选欧67/欧12接口
- ▶ 可选配双截
- ▶ 导轨供油润滑系统
- ▶ 中板模到位安全检测
- ▶ 围栏门型外安全检测
- ▶ Quick switch jig
- ▶ Sprue shearing system
- ▶ Multi-set clip & suction circuits available
- ▶ Default language selectable
- ▶ Select from forward and backward placement positions
- ▶ Select from Euromap 67 and Euromap 12 interfaces
- ▶ Double sections
- ▶ Lubrication system for guide rail
- ▶ Safety inspection of middle plate mold
- ▶ Safety inspection of fence door

产品参数 Specification

机型 Model	轴数 Axis	主臂最远位置 Farthest Position of Main Arm X1 (mm)	主臂引拔行程 Crosswise Stroke of Main Arm X2 (mm)	副臂最远位置 Farthest Position of Auxiliary Arm X3 (mm)	副臂引拔行程 Crosswise Stroke of Auxiliary Arm X4 (mm)	副臂最近位置 Closest Position of Auxiliary Arm X5 (mm)	手臂上下行程 Arm's Upper /Lower Stroke Y (mm)	待机高度 Standby Height YM1 (mm)	安装面下行长度 Downward Stroke of Mounting Surface YM2 (mm)	机器宽度 Machine Width W (mm)	机器长度 Machine Length L (mm)	横行程 Traverse Stroke Z (mm)	机器高度 Machine Height H (mm)	底座高度 Base Height Hs (mm)	负载 Load Payload (kg)	适用注塑机 Applicable Injection Molding Machine IMM (ton)
YR800S5-E	5	980	640	165	645	170	800	385	415	1500	2320	1350	1840	530	3	50-200
YR1000S5-E	5	980	640	815	645	170	1000	385	615	1500	2640	1650	2080	530	3	150-350
YR1000S5-DE	5	1025	605	250	590	170	1000	475	525	1610	2780	1750	1930	620	8	150-350
YR1200S5-DE	5	1025	605	250	590	170	1200	475	725	1610	3020	2000	2050	620	8	200-550

※ 页面所有数据均来源于伊之密工厂，请以实际定制设备情况为准
The Data above were acquired by testing in the factory, only for your reference.
The specific data please accord to the actual equipment.

中型三轴横走式机械手

MEDIUM-SIZED THREE-AXIS TRAVERSE ROBOT



高精度传动机构

High accuracy transmission mechanism

高精度滑轨配合精密齿轮传动机构以实现低震动高速运动,确保机构低噪音超高速等特点

The coordination of the high precision slide-rail and precision gear transmission mechanism enables the arm to move at high speed with low vibration. The transmission mechanism also features low noise and super high speed, etc.



全开放式模块化设计

Fully open modular design

全开放式简洁布局及模块化设计便于维护,正反向安装变更更加方便,治具采用便挂式组装,根据人性化设计。

Fully open, concise layout and modular design are convenient for maintenance. Forward and reverse installation is interchangeable. Easily mounted fixtures are more user-friendly, available.



欧洲概念设计

European concept based design

精巧严谨的结构,运转顺畅、快速、平稳

Sophisticated structure and smooth, fast and steady operation

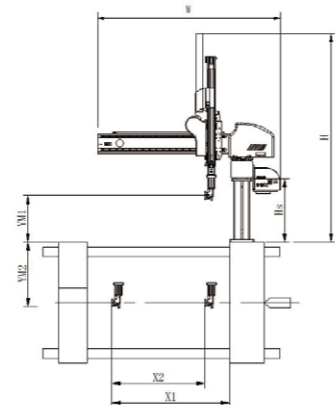
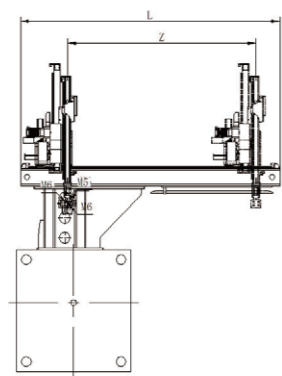
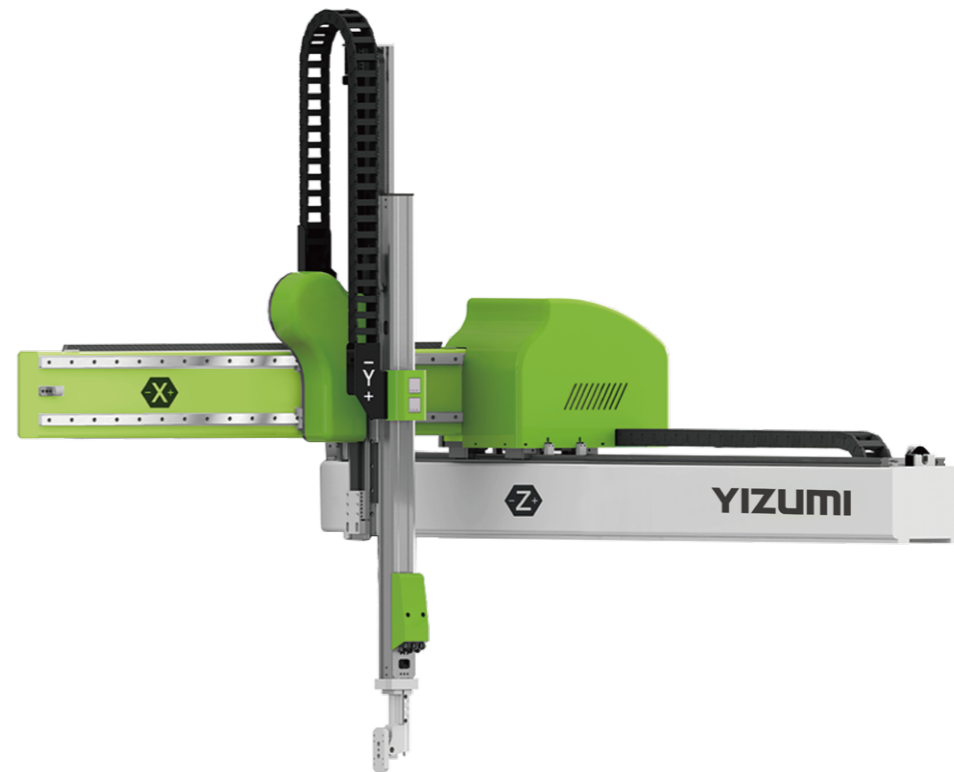

标配表 Standard Features

- ▶ 标准治具
- ▶ 两吸两抱
- ▶ 语言:中英文
- ▶ 开放式自由编程
- ▶ 输送带启动信号
- ▶ 松下伺服驱动
- ▶ Standard jig
- ▶ Two sets of clip & suction
- ▶ Language: Chinese/English
- ▶ Open programming
- ▶ Conveyor start signal
- ▶ Panasonic servo

选配表 Optional Features

- ▶ 快换治具模块
- ▶ 水口剪刀系统
- ▶ 可选多组吸抱回路
- ▶ 可选定制语言
- ▶ 正反向置物可选
- ▶ 可选欧67/欧12接口
- ▶ 可选配双截
- ▶ 导轨供油润滑系统
- ▶ 中板模到位安全检测
- ▶ 安全门型外安全检测
- ▶ Quick switch jig
- ▶ Sprue shearing system
- ▶ Multi-set clip & suction circuits available
- ▶ Default language selectable
- ▶ Select from forward and backward placement positions
- ▶ Select from Euromap 67 and Euromap 12 interfaces
- ▶ Double sections
- ▶ Lubrication system for guide rail
- ▶ Safety inspection of middle plate mold
- ▶ Safety inspection of safety door

产品参数 Specification

机型 Model	轴数 Axis	主臂最远位置 Farthest Position of Main Arm	主臂引拔行程 Crosswise Stroke of Main Arm	副臂最远位置 Farthest Position of Auxiliary Arm	副臂引拔行程 Crosswise Stroke of Auxiliary Arm	副臂最近位置 Closest Position of Auxiliary Arm	手臂上下行程 Arm's Upper /Lower Stroke	待机高度 Standby Height	安装面下行长度 Downward Stroke of Mounting Surface	机器宽度 Machine Width	机器长度 Machine Length	横行程 Traverse Stroke	机器高度 Machine Height	底座高度 Base Height	负载 Load	适用注塑机 Applicable Injection Molding Machine
		X1 (mm)	X2 (mm)	X3 (mm)	X4 (mm)	X5 (mm)	Y (mm)	YM1 (mm)	YM2 (mm)	W (mm)	L (mm)	Z (mm)	H (mm)	Hs (mm)	Payload (kg)	IMM (ton)
YR1200S3-D	3	1060	840	/	/	/	1200	420	780	1590	2340	1700	2000	570	8	200-550
YR1500S3-D	3	1480	1180	/	/	/	1500	450	1050	2365	3120	2380	2280	700	15	450-1000

※ 页面所有数据均来源于伊之密工厂, 请以实际定制设备情况为准
The Data above were acquired by testing in the factory, only for your reference.
The specific data please accord to the actual equipment.

中型五轴横走式机械手

MEDIUM-SIZED FIVE-AXIS TRAVERSE ROBOT



高精度传动机构

High accuracy transmission mechanism

高精度滑轨配合精密齿轮传动机构以实现低震动高速运动, 确保机构低噪音超高速等特点

The coordination of the high precision slide-rail and precision gear transmission mechanism enables the arm to move at high speed with low vibration. The transmission mechanism also features low noise and super high speed, etc.



全开放式模块化设计

Fully open modular design

全开放式简洁布局及模块化设计便于维护, 正反向安装变更更加方便, 治具采用便挂式组装, 根据人性化设计。

Fully open, concise layout and modular design are convenient for maintenance. Forward and reverse installation is interchangeable. Easily mounted fixtures are more user-friendly. available.



欧洲概念设计

European concept based design

精巧严谨的结构, 运转顺畅、快速、平稳

Sophisticated structure and smooth, fast and steady operation

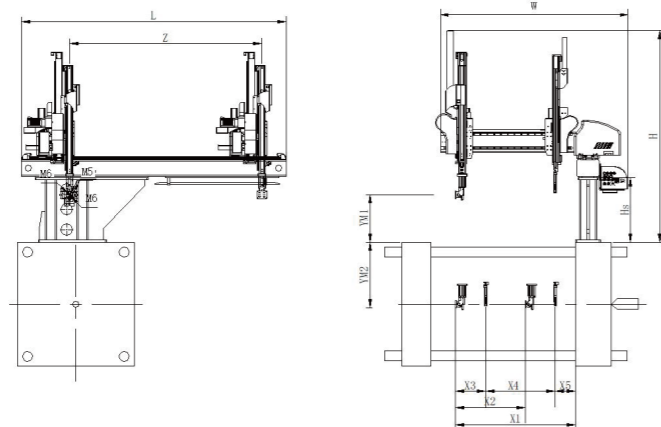
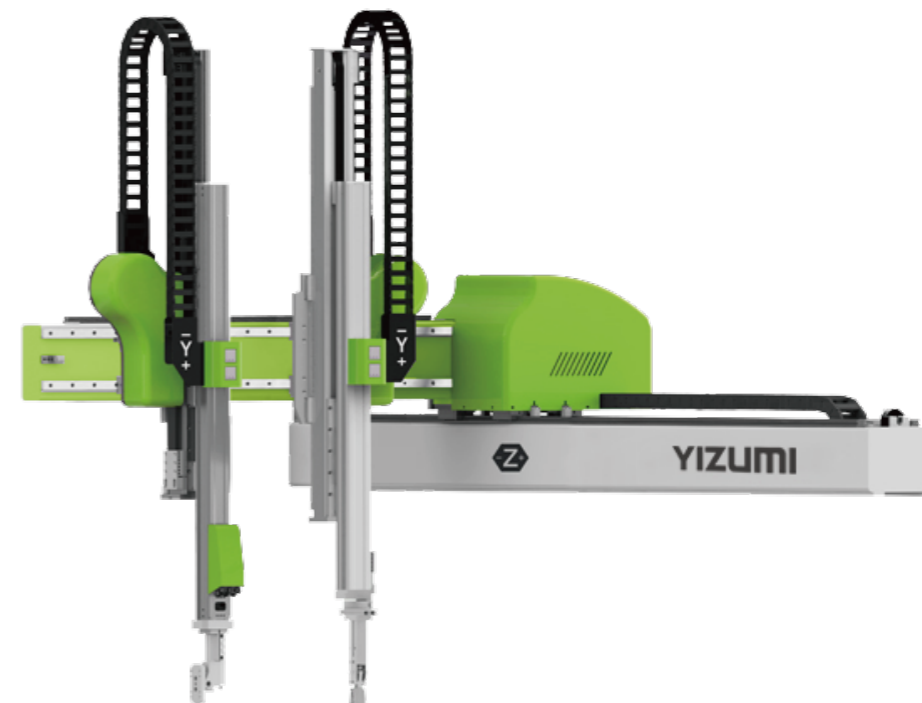

标配表 Standard Features

- ▶ 标准治具
- ▶ 两吸两抱
- ▶ 语言: 中英文
- ▶ 开放式自由编程
- ▶ 输送带启动信号
- ▶ 松下伺服驱动
- ▶ Standard jig
- ▶ Two sets of clip & suction
- ▶ Language: Chinese/English
- ▶ Open programming
- ▶ Conveyor start signal
- ▶ Panasonic servo

选配表 Optional Features

- ▶ 快换治具模块
- ▶ 水口剪刀系统
- ▶ 可选多组吸抱回路
- ▶ 可选定制语言
- ▶ 正反位置物可选
- ▶ 可选欧67/欧12接口
- ▶ 可选配双截
- ▶ 导轨供油润滑系统
- ▶ 中板模到位安全检测
- ▶ 安全门型外安全检测
- ▶ Quick switch jig
- ▶ Sprue shearing system
- ▶ Multi-set clip & suction circuits available
- ▶ Default language selectable
- ▶ Select from forward and backward placement positions
- ▶ Select from Euromap 67 and Euromap 12 interfaces
- ▶ Double sections
- ▶ Lubrication system for guide rail
- ▶ Safety inspection of middle plate mold
- ▶ Safety inspection of safety door

产品参数 Specification

机型 Model	轴数 Axis	主臂最远位置 Farthest Position of Main Arm	主臂引拔行程 Crosswise Stroke of Main Arm	副臂最远位置 Farthest Position of Auxiliary Arm	副臂引拔行程 Crosswise Stroke of Auxiliary Arm	副臂最近位置 Closest Position of Auxiliary Arm	手臂上下行程 Arm's Upper /Lower Stroke	待机高度 Standby Height	安装面下行长度 Downward Stroke of Mounting Surface	机器宽度 Machine Width	机器长度 Machine Length	横行程 Traverse Stroke	机器高度 Machine Height	底座高度 Base Height	负载 Load	适用注塑机 Applicable Injection Molding Machine
		X1 (mm)	X2 (mm)	X3 (mm)	X4 (mm)	X5 (mm)	Y (mm)	YM1 (mm)	YM2 (mm)	W (mm)	L (mm)	Z (mm)	H (mm)	Hs (mm)	Payload (kg)	IMM (ton)
YR1200S5-D	5	1060	615	265	615	180	1200	420	780	1690	2340	1700	2000	570	8	200-550
YR1500S5-D	5	1480	734	516	734	230	1500	450	1050	2250	3120	2300	2290	700	15	450-1000

※ 页面所有数据均来源于伊之密工厂, 请以实际定制设备情况为准
The Data above were acquired by testing in the factory, only for your reference.
The specific data please accord to the actual equipment.

大型三轴机械手 (牛头式)

LARGE-SIZED THREE-AXIS ROBOT (OX-HEAD TYPE)



精密线性滑轨

Precision linear guide rail



铝合金挤型手臂

Aluminum extrusion arm



全开放式模块化设计

Fully open modular design

横梁型钢加焊扁铁工艺

Structural steel combined with welded flat iron

横梁型钢加焊扁铁工艺, 增加滑轨安装面的精度, 锁紧力及强度。

The beam is made of structural steel and welded flat iron, increasing the precision, locking force and strength of the rail mounting surface.

引拔一体化设计

Integrated crosswise design

引拔和电箱完美结合, 电箱内置于引拔内

Perfect combination: The electrical cabinet is installed in the crosswise.

牛头式布局

OX-head layout

重心后置致使用力臂更短, 耐用性更高, 且增加更多的夹具应用空间范围

Rear gravity makes the arm of force shorter, increases the durability and adds more space to the gripper.

可选配伺服B、C轴 (A+B+C轴可选)

Optional servo B / C axis (A+B+C axes are optional)

使后续工艺处理更灵活且精度更高

Subsequent processing is more flexible and accurate.

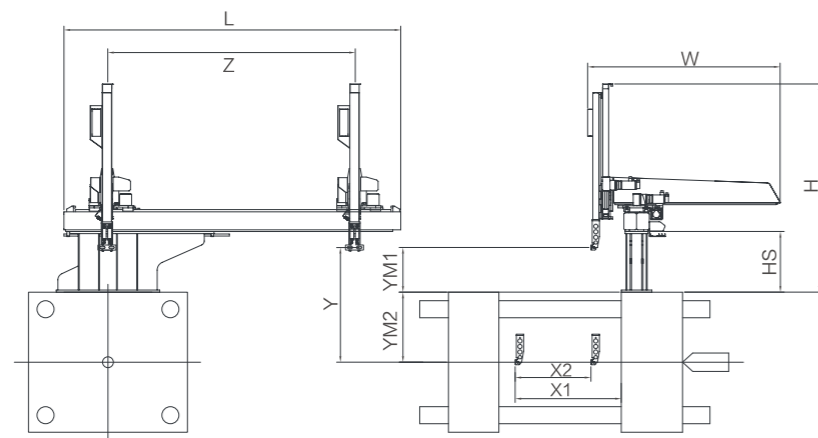

标配表 Standard Features

- ▶ 两吸两抱
- ▶ 语言: 中英文
- ▶ 开放式自由编程
- ▶ 三相变压器
- ▶ 输送带启动信号
- ▶ 松下伺服驱动
- ▶ Two sets of clip & suction
- ▶ Language: Chinese/English
- ▶ Open programming
- ▶ Three-phase transformer
- ▶ Conveyor start signal
- ▶ Panasonic servo

选配表 Optional Features

- ▶ 快换治具
- ▶ 水口剪刀系统
- ▶ 可选多组吸抱回路
- ▶ 可选定制语言
- ▶ 正反向置物可选
- ▶ 可选维修平台
- ▶ 可选欧67/欧12接口
- ▶ AC&BC轴
- ▶ Quick switch jig
- ▶ Sprue shearing system
- ▶ Multi-set clip & suction circuits available
- ▶ Default language selectable
- ▶ Select from forward and backward placement positions
- ▶ Optional maintenance platform
- ▶ Select from Euromap 67 and Euromap 12 interfaces
- ▶ AC&BC axis

产品参数 Specification

机型 Model	轴数 Axis	主臂最近位置 Farthest Position of Main Arm	主臂引拔行程 Crosswise Stroke of Main Arm	副臂最近位置 Farthest Position of Auxiliary Arm	副臂引拔行程 Crosswise Stroke of Auxiliary Arm	副臂最近位置 Closest Position of Auxiliary Arm	手臂上下行程 Arm's Upper /Lower Stroke	待机高度 Standby Height	安装面下行长度 Downward Stroke of Mounting Surface	机器宽度 Machine Width	机器长度 Machine Length	横行程 Traverse Stroke	机器高度 Machine Height	底座高度 Base Height	负载 Load	适用注塑机 Applicable Injection Molding Machine
		X1 (mm)	X2 (mm)	X3 (mm)	X4 (mm)	X5 (mm)	Y (mm)	YM1 (mm)	YM2 (mm)	W (mm)	L (mm)	Z (mm)	H (mm)	Hs (mm)	Payload (kg)	IMM (ton)
YR1800N3-D	3	1770	1320	/	/	/	1800	650	1150	2480	4160	3120	2650	700	15	500-1300
YR2200N3-D	3	2130	1680	/	/	/	2200	650	1550	2840	4160	3120	2830	700	15	700-1800

※ 页面所有数据均来源于伊之密工厂, 请以实际定制设备情况为准
The Data above were acquired by testing in the factory, only for your reference.
The specific data please accord to the actual equipment.

大型三轴机械手 (牛头式)

LARGE-SIZED THREE-AXIS ROBOT (OX-HEAD TYPE)



大负荷

超大的负重能力, 满足不同的生产需求。
High payload capacity meets different production needs.



精密性齿轮传动机构

Precision gear transmission mechanism

全轴AC伺服

AC servo axes

全闭环式控制保证机器运动精度及可靠性, 教导式自由编辑程式操作便利, 为多种语种菜单式真彩触摸屏操作界面。

Fully closed-loop control ensures the accuracy and reliability of the movements. Intuitive free programming is convenient for operation. A true color touch screen with multi-language menu style interface is available.

牛头式布局

OX-head layout

重心后置致使用力臂更短, 耐用性更高, 且增加更多的治具应用空间范围

Rear gravity makes the arm of force shorter, increases the durability and adds more space to the gripper.



可选配伺服C轴 (A+B+C轴可选)

Optional servo C axis (A+B+C axes are optional)

使后续工艺处理更灵活且精度更高

Subsequent processing is more flexible and accurate.

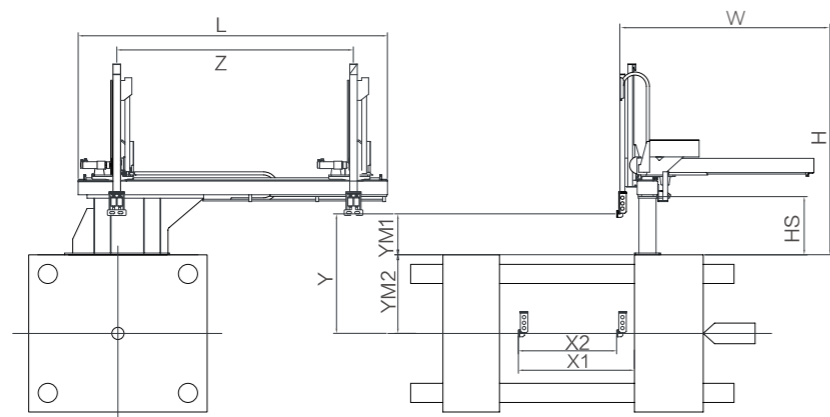

标配表 Standard Features

- ▶ 两吸两抱
- ▶ 语言: 中英文
- ▶ 开放式自由编程
- ▶ 三相变压器
- ▶ 输送带启动信号
- ▶ 供油润滑系统
- ▶ 松下伺服驱动
- ▶ Two sets of clip & suction
- ▶ Language: Chinese/English
- ▶ Open programming
- ▶ Three-phase transformer
- ▶ Conveyor start signal
- ▶ Oil supply lubrication system
- ▶ Panasonic servo

选配表 Optional Features

- ▶ 快换治具
- ▶ 水口剪刀系统
- ▶ 可选多组吸抱回路
- ▶ 可选定制语言
- ▶ 正反方向置物可选
- ▶ 可选维修平台
- ▶ 可选欧67/欧12接口
- ▶ AC&BC轴
- ▶ 安全门型外安全检测
- ▶ Standard jig
- ▶ Sprue shearing system
- ▶ Multi-set clip & suction circuits available
- ▶ Default language selectable
- ▶ Select from forward and backward placement positions
- ▶ Optional maintenance platform
- ▶ Select from Euromap 67 and Euromap 12 interfaces
- ▶ AC & BC axis
- ▶ Safety inspection of safety door

产品参数 Specification

机型 Model	轴数 Axis	主臂最远位置 Farthest Position of Main Arm	主臂引拔行程 Crosswise Stroke of Main Arm	副臂最远位置 Farthest Position of Auxiliary Arm	副臂引拔行程 Crosswise Stroke of Auxiliary Arm	副臂最近位置 Closest Position of Auxiliary Arm	手臂上下行程 Arm's Upper /Lower Stroke	待机高度 Standby Height	安装面下行长度 Downward Stroke of Mounting Surface	机器宽度 Machine Width	机器长度 Machine Length	横行程 Traverse Stroke	机器高度 Machine Height	底座高度 Base Height	负载 Load	适用注塑机 Applicable Injection Molding Machine
		X1 (mm)	X2 (mm)	X3 (mm)	X4 (mm)	X5 (mm)	Y (mm)	YM1 (mm)	YM2 (mm)	W (mm)	L (mm)	Z (mm)	H (mm)	Hs (mm)	Payload (kg)	IMM (ton)
YR2500N3-D	3	2250	1720	/	/	/	2500	710	1790	3000	5050	4000	3200	900	50	1000-2500
YR3000N3-D	3	2250	1720	/	/	/	3000	710	2290	3000	5050	4000	3440	900	75	1500-4000

※ 页面所有数据均来源于伊之密工厂, 请以实际定制设备情况为准
The Data above were acquired by testing in the factory, only for your reference.
The specific data please accord to the actual equipment.

高速机械手

HIGH-SPEED ROBOT

数显可视化强

Digital display

设置方便全程监控

Easy settings and whole-process monitoring

高惯量全轴AC伺服驱动

High-inertia AC servo motor driven axis

全闭环式控制保证机器运动精度及可靠性, 教导式自由编辑程式操作便利, 为多种语种菜单式真彩触摸屏操作界面。

Fully closed-loop control ensures the accuracy and reliability of the movements. Intuitive free programming is convenient for operation. A true color touch screen with multi-language menu style interface is available.

高精度传动机构

High accuracy transmission mechanism

高精度滑轨配合精密齿轮传动机构以实现低振动高速运动, 确保机构低噪音超高速等特点。

The coordination of the high precision slide-rail and precision gear transmission mechanism enables the arm to move at high speed with low vibration. The transmission mechanism also features low noise and super high speed, etc.

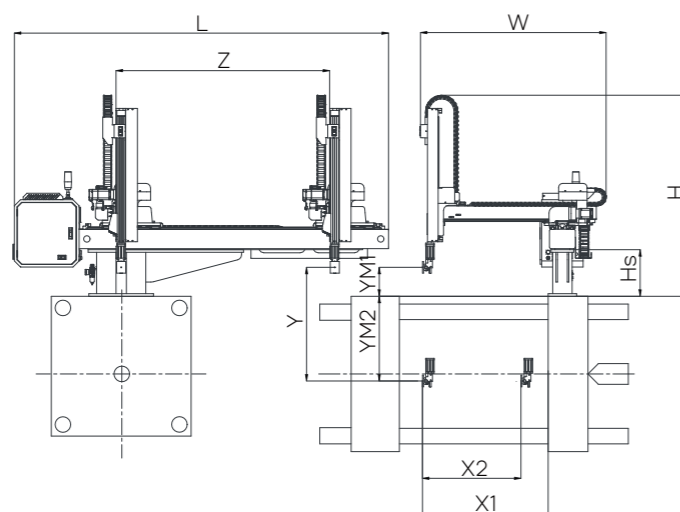

标配表 Standard Features

- ▶ 标准治具
- ▶ 两吸两抱
- ▶ 语言: 中英文
- ▶ 输送带启动信号
- ▶ 型外安全检测
- ▶ Standard jig
- ▶ Two sets of clip & suction
- ▶ Language: Chinese/English
- ▶ Conveyor start signal
- ▶ External safety inspection

选配表 Optional Features

- ▶ 快换治具
- ▶ 可选定制语言
- ▶ 正反向置物可选
- ▶ 可选欧67/欧12接口
- ▶ 安全门型外安全检测
- ▶ Quick switch jig
- ▶ Default language selectable
- ▶ Select from forward and backward placement positions
- ▶ Select from Euromap 67 and Euromap 12 interfaces
- ▶ Safety inspection of safety door

产品参数 Specification

机型 Model	轴数 Axis	主臂最近位置 Farthest Position of Main Arm	主臂引拔行程 Crosswise Stroke of Main Arm	副臂最近位置 Farthest Position of Auxiliary Arm	副臂引拔行程 Crosswise Stroke of Auxiliary Arm	副臂最近位置 Closest Position of Auxiliary Arm	手臂上下行程 Arm's Upper /Lower Stroke	待机高度 Standby Height	安装面下行长度 Downward Stroke of Mounting Surface	机器宽度 Machine Width	机器长度 Machine Length	横行程 Traverse Stroke	机器高度 Machine Height	底座高度 Base Height	负载 Load	适用注塑机 Applicable Injection Molding Machine
		X1 (mm)	X2 (mm)	X3 (mm)	X4 (mm)	X5 (mm)	Y (mm)	YM1 (mm)	YM2 (mm)	W (mm)	L (mm)	Z (mm)	H (mm)	Hs (mm)	Payload (kg)	IMM (ton)
YR1200H3-D	3	950	720	/	/	/	1200	425	775	1440	2710	1650	1780	580	5	150-450

※ 页面所有数据均来源于伊之密工厂, 请以实际定制设备情况为准
The Data above were acquired by testing in the factory, only for your reference.
The specific data please accord to the actual equipment.

模内贴标系统

IN-MOLD LABELING SYSTEM



更高速
Faster

最快时间只需3秒以内即可完成整个贴标、取出、排列等生产周期。

It takes no more than 3 seconds for the system to complete the whole cycle, including labeling, removal and placement.



更稳定
More stable

掉标率仅为千分之二。

Defective rate is less than 0.2%.



更环保
More environmental protect

一体成型效果永久, 精美印刷, 具环保材质, 产品附加值更高。

The integrated injection molding process produces parts with wear-resistant, well-printed and eco-friendly labels, as well as higher added value.

灵活的卡匣堆叠设计

Flexible cartridge and stacking system design

卡匣、堆叠系统方向灵活, 支持快捷转换。

The direction of the cartridge and stacking system is flexible and quick change is available.

机械结构设计 (模块化、轻量化)

Modular and lightweight mechanical design

机械结构设计经过有限元受力分析等措施, 保证各标准件使用寿命长, 运行稳定, 机械结构设计最合理, 设备性能最优化, 为整套设备的稳定高效运行提供强有力技术保障。

Measures like finite element analysis are applied to the mechanical structure design to ensure long lifespan of the components, stable and efficient operation, the best structure design and optimum performance of the whole equipment.



▲ YR833S



▲ YR833-S6



▲ YR850-S3

标配表 Standard Features

- ▶ 非标治具1套
- ▶ 标配输送带
- ▶ 标配变压器
- ▶ Non-standard jig x 1 set
- ▶ Standard conveyor
- ▶ Standard transformer

选配表 Optional Features

- ▶ 选配多套治具
- ▶ 可选欧67/欧12接口
- ▶ 视觉检测
- ▶ Quick switch jig
- ▶ Select from Euromap 67 and Euromap 12 interfaces
- ▶ Visual inspection

产品参数 Specification

机型 Model	轴数 Axis	主臂最近位置 Farthest Position of Main Arm	主臂引拔行程 Crosswise Stroke of Main Arm	副臂最近位置 Farthest Position of Auxiliary Arm	副臂引拔行程 Crosswise Stroke of Auxiliary Arm	副臂最近位置 Closest Position of Auxiliary Arm	手臂上下行程 Arm's Upper /Lower Stroke	待机高度 Standby Height	安装面下行长度 Downward Stroke of Mounting Surface	机器宽度 Machine Width	机器长度 Machine Length	横行程 Traverse Stroke	机器高度 Machine Height	底座高度 Base Height	负载 Load	适用注塑机 Applicable Injection Molding Machine
		X1 (mm)	X2 (mm)	X3 (mm)	X4 (mm)	X5 (mm)	Y (mm)	YM1 (mm)	YM2 (mm)	W (mm)	L (mm)	Z (mm)	H (mm)	Hs (mm)	Payload (kg)	IMM (ton)
YR833-S6	/	/	190+190	/	/	/	750	/	/	2150	3280	2380	2150	/	8	150-450
YR850-S3	/	/	610	/	/	/	1150	/	/	2350	3730	2820	2260	/	10	350-700
YR833S	/	/	190+190	/	/	/	400	/	/	2410	2730	2100	1720	/	5	150-450

※ 页面所有数据均来源于伊之密工厂, 请以实际定制设备情况为准
The Data above were acquired by testing in the factory, only for your reference.
The specific data please accord to the actual equipment.

多轴伺服控制器

MULTI-AXIS SERVO CONTROLLER



- 8.4寸触摸屏;
 - 采用了多CPU控制、系统响应速度快,动作控制精度高,定位精度0.01mm;
 - 堆叠、用户教导、电动调位等多项功能。动作为示教模式,满足客户的各种控制需求;
 - 实时检测机器运行情况,及时显示故障报警及故障原因,确保机器的使用安全;
 - 可控制6个伺服轴进行动作,可扩展IO口,满足机器外部复杂控制;
 - 机器参数,模号程序均可通过U盘在不同机器间导入导出;
 - 可随时使用U盘更新最新系统,持续获得稳定支持;
-
- 8.4 Inches Touch Screen HMI;
 - Multiple CPU control improves system response and movement accuracy, movement precision up to 0.01mm;
 - The function of stacking, teaching, step by step adjusting meet different needs of the customer;
 - Real-time operation monitoring and protection function will alarm and show the trouble details immediately to ensure the safety of the machine;
 - To easily meet the requirement of complex automation system, it can control up to 6 axis as well as the extension IO points;
 - Convenient to upgrade the program and specification with USB Key among different machines;
 - The operation system could be upgraded by USB Key for continued technical support;

YIZUMI

THINK
TECH FORWARD

技术
更进一步